

CHAINS

1/4 Cor Bet  
Sec 18,19.  
T.1.S.R.9.  
W.

1/4 Cor witness on Latimer road.  
Stump 60" N36-25W 228 Feet.  
Spruce 36" N17,25E 281 Feet.  
2" iron pipe  
W.E. Anderson Sr. W.E. Anderson Jr. Aug 1949.

1/4 Cor Bet  
Sec 5,6.  
T.2.S.R.  
9.W.

Shiner in tree front of Louie Affemeyer. N67-30W 61.16 Feet.  
Shiner in maple 14" S67-30E 72.05 Feet.  
W.E. Anderson Sr. W.E. Anderson Jr. Aug 1949.

Sec Cor  
Sec 27,28,  
33,34. T.  
4.S.R.10.  
W.

1" iron pipe edge of highway 101.  
Tripple Willow 10" Bears S49-OE 25.8 Feet.  
" " " " 10" Bears N85-30E 94.6 Feet.

1/4 cor.  
18  
19

1/4 Cor Bet  
Sec 19,20.  
T.4.S.R.  
10.W.

2" iron pipe badley rusted.  
Spruce 24" Bears S22-OW 11.66 Feet.  
Alder 8" old B.T. S33-OE 22.5 Feet.  
W.E. Anderson Sr. W.E. Anderson Jr. In the year 1949.

Sec Cor  
Sec 28,29,  
32,33, T.  
4.S.R.10.  
W.

Found old spruce limb on fence line ES-OW marks visible.  
Set 1/2" gal pipe made around of red. around of rock  
W.E. Anderson Sr. June 30, 1949.

1/4 Cor Bet  
Sec 9,16.  
T.2.S.R.9.  
W.

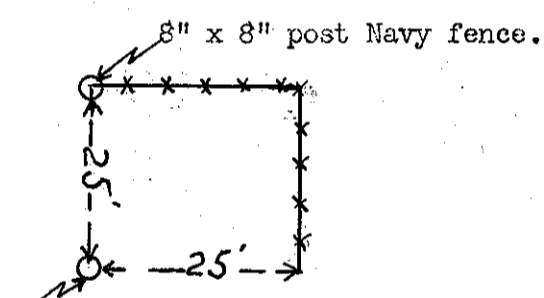

1/4 Cor set 2" iron pipe  
In the presence of W.E. Anderson Sr. W.E. Anderson Jr.  
Aug 15, 1949.

N.E. Cor  
of the S.  
E. 1/4 of the  
S.E. 1/4 of  
Sec 9.T.2.  
S.R.9.W.

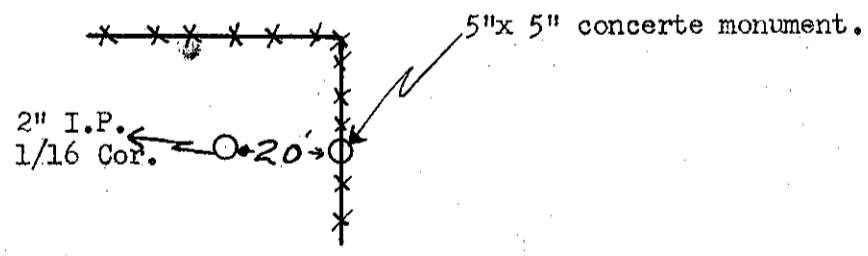

In the presence of W.E. Anderson Sr. W.E. Anderson Jr.  
In the year of 1949.

Sec. Cor. to  
sec 9,10,  
15,16. T.  
2.S.R.9.W.

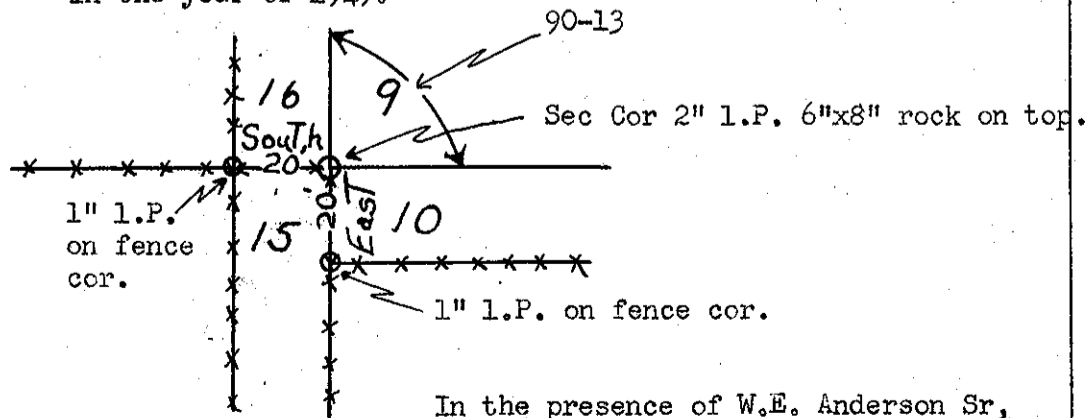

In the presence of W.E. Anderson Sr,  
W.E. Anderson Jr. In the year of 1949.